



Park Model

NATION

COMFORTABLE. AFFORDABLE LIVING.

ELKRIDGE

SINGLE STORY MODEL WITH HIGH CEILINGS

1 Bed | 1 Bath | 398.6 SF

WIDTH 11'2" | LENGTH 35' | 398.6 SQFT
(measurements are approximate)

pricing starting at

\$57,999



This Park Model RV is built in accordance with ANSI A119.5 standards and is approved by the Washington State Department of Labor & Industries (L&I).



Images may show optional upgrades not included in the base model. Please refer to your sales representative.

LICENSE #605222408

CALL NOW

(360) 301-8322



Info@parkmodelnation.com



184 Cowlitz Loop Rd.
Toledo, WA, 98591.

ELKRIDGE

SINGLE STORY MODEL WITH HIGH CEILINGS



Park Model NATION

COMFORTABLE. AFFORDABLE LIVING.

pricing starting at

\$57,999

1 Bed | 1 Bath | 398.6 SF

*All prices are subject to change without prior notice and are not guaranteed, except for those of existing orders. Prices listed do not include sales tax, delivery charges, set-up, skirting or installation.

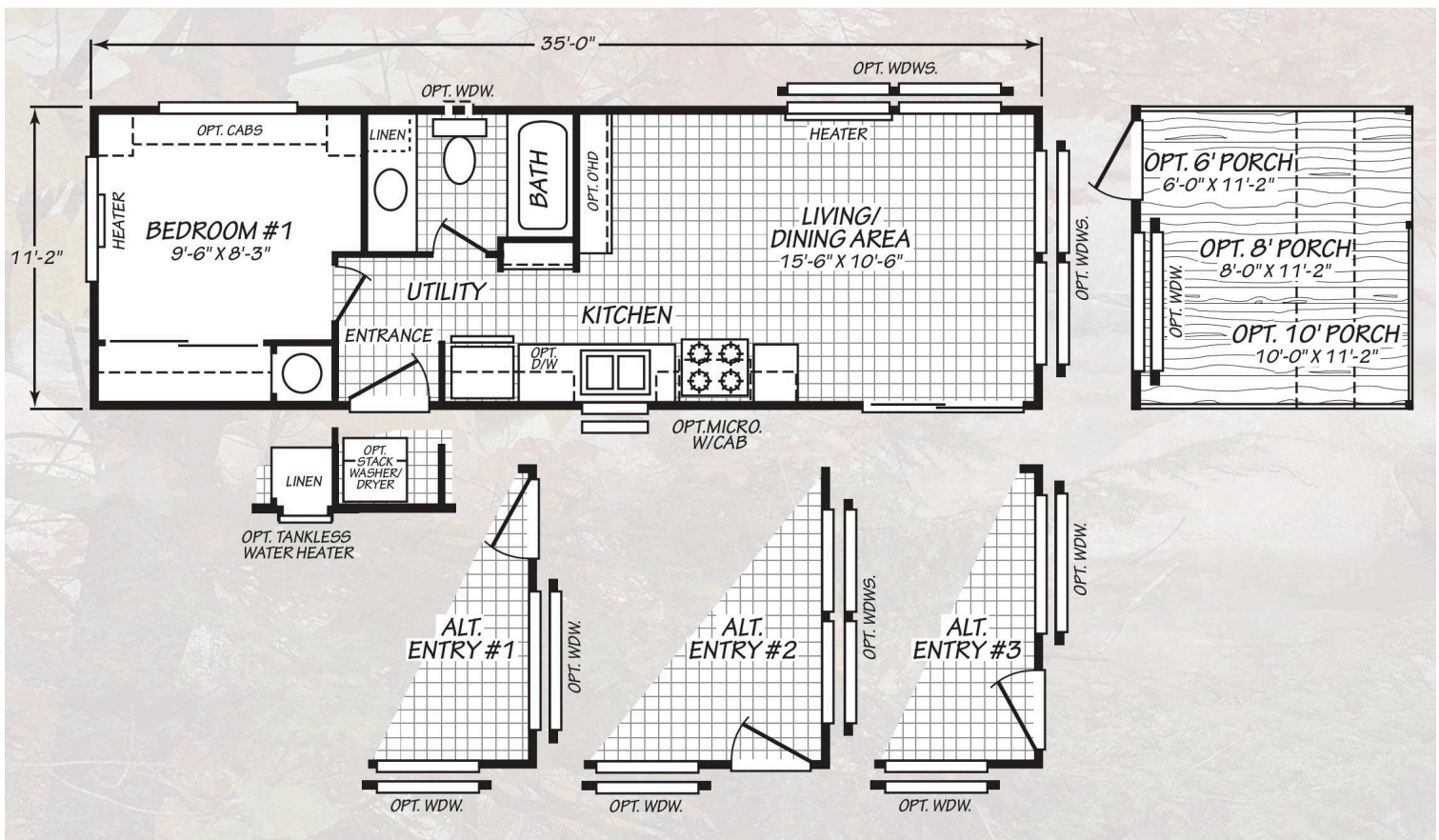

Due to continuous product development and improvement, prices, specifications and materials are subject to change without notice or obligation. Square footage and other dimensions are approximate. Images such as rendering, photos and floor plans may be shown with optional features and/or third party additions that may not be available in all regions.

LICENSE #605222408

CALL NOW

(360) 301-8322



Info@parkmodelnation.com



184 Cowlitz Loop Rd.
Toledo, WA, 98591.

ELKRIDGE, STANDARD FEATURES

8/22/2025

GENERAL CONSTRUCTION	Cascadia Special Edition
Insulation: Ceilings/Walls/Floors	R21 ceiling, R11 sidewalls, R11 floors
Window Type	Vinyl frame, dual glazed, Argon gas filled. Low E coating.
Floor Joists	2" x 6"; 16" On Center
Exterior Siding Type	4 rows of Allura lap on bottom- LP Smart Panel above- all 4 sides.
Exterior Window Trim	Fiber Cement
Sidewalls	2" X 4"; 16" On Center
Shingles	Architectural
Roof Venting	Ridge Vent Standard
Standard Roof Load	30 lb. with trusses 24" on center
Main Entry Door	6' Sliding glass door.
Eaves & Overhang	Nominal 12" Hitch end overhang. Nominal 6" sidewall eave. Flush rear end.
Porches	Optional
Roof Pitch	6/12 on Y Model. 2/12 on X model.
Bay Window	Not available
Hitch-end exterior bay window trim.	NA
FLOORING COVERING	
Carpet & Carpet Pad	Level 1 carpet and 3/8" 4# rebond pad
Linoleum	Living room, kitchen/dining, bath and hall.
Main Entry Floor Covering	Lino
INTERIOR	
Window Sills & Trim	White panel surrounds with white trim on sides and top. Bottom sill is white bullnose MDF.
Closet Shelves	Wire
Tape & Texture Interior Wall Finish	Standard throughout. Ceiling to wall transition is caulked and painted.
Interior Wall Paint	Alabaster
Ceiling Paint	Alabaster
Base Molding	3-1/4" in lino areas.
Interior Doors	White raised two panel.
Door Trim	2-1/4" white waterfall.
Door Stops	None
Door Handles	Round brushed nickel.
Wardrobe Doors	White raised panel sliding doors
LIGHTING/ELECTRICAL	
Bedroom Lighting	Switched recept.
Dining Room Lighting	Recessed LED can light.
Kitchen Lighting	Recessed LED can lights.
Exterior Lights	Black carriage.
Bathroom Lighting	Recessed LED can light.
Wire & Brace For Ceiling Fan(s)	Optional
TV/Phone Boxes - Rough In With Raceways - Not Wired	Optional
Electrical Service Main Panel	Interior 50 amp panel box. 50 Amp pigtail. 100 amp option does not come with a pigtail- must be hard wired.
CABINETS	
Cabinet Type	Knotty Alder face frame with Knotty Alder doors and hidden hinges.
Kitchen Overhead Cabinets	12351Y-42" tall; 12351X- 30" tall. Both with 1 adjustable shelf.
Cabinet Hardware	Brushed nickel round knobs.
Range Hood Overhead Cabinet	Standard range hood and cabinet on 12351X. 12351Y has a floating stainless range hood.
Refer Overhead	Shelf
Kitchen Drawers	One bank of drawers.
Cabinet Crown Molding	Standard
Bathroom Drawer Bank	Not available
Countertop, Backsplash and Self Edge - Kitchen and Baths	Laminate
PLUMBING/HVAC	
Bathroom Tub/Shower	54" Fiberglass
Bath Sinks & Toilets	Oval China Sink; Elongated Toilet
Bath Sink Faucets & Tub/Shower Faucets	Brushed Nickle Single Lever
Bathroom Mirrors	Size varies per bath design.
Towel Bar/Tissue Holders	Optional
Kitchen Sink	Stainless steel; 50/50
Kitchen Faucet	Single lever with side sprayer
Plumb for Washing Machine	Optional
Wire for Clothes Dryer	Optional. Electric dryer prep requires 100 amp service. Dryer vent hole not cut out by plant- homeowner must cut once they have their dryer.
Shut-Off Valves	Optional on fixtures. Whole house not available.
Exterior Water Faucet	Optional
Heating System	Electric baseboard heaters. Location and size vary by model.
Water Heater	20 gallon electric.
WINDOW TREATMENTS	
Mini Blinds	2" faux wood blinds. Loft windows and bath windows do not get blinds. No cornices or fabric.
Vertical Blind on SGD	Standard
APPLIANCES	
Color	Stainless steel.
Refrigerator	Minimum 18 cubic foot top/bottom.
Range	30" natural gas range. Comes with a ship loose propane orifice for customer install if necessary.
Dishwasher	All models 18" dishwasher optional.
Microwave	Optional
Range Hood	Standard hood and cabinet on 12351X. 12351Y has a floating stainless range hood.
Fireplace	Electric fireplace optional.